

Schlüter®-SHOWERPROFILE-S / -R

Drainage
Floor-level showers

14.1

Product data sheet

Application and function

Schlüter-SHOWERPROFILE-S is a 2-part profile system, comprised of a support profile and a triangular profile, for covering the sloped edges that are created when installing floor-level showers with linear drainage systems. The triangular profile made of stainless steel V4A – which is available with either a brushed finish or a high-quality powder coating – has a fleece fabric laminated on the reverse side for bonding with the tile adhesive and is inserted into the groove of the plastic support profile. The profile can be used as a lateral wall transition or as a lateral transition to the adjoining floor.

The **SHOWERPROFILE-SA** and **-SB** are available in 6 different heights for shower floor covering thicknesses from 6 mm to 22 mm. The triangular profiles, which are supplied in lengths of 120 cm to 200 cm, have a height of 6 or 10 mm at the low side (H1) and feature a slope of 2% (increase of 2 mm for each 10 cm section)

The profile is shortened at the low and/or high side to produce the necessary profile height and length. Additional height variability can be achieved by inserting into the support profile at a specific depth.

The **Schlüter-SHOWERPROFILE-SC** has been developed for use in combination with the Schlüter-KERDI-SHOWER-LTS sloping board (surface slope 1.25%).

The support profile is available in a length of 200 cm and is suitable for shower floor covering thicknesses of 6 mm to 15 mm. The triangular profile is 249 cm long, has a height of 6 mm at the low side (H1) and features a slope of 1.25% (increase of 1.25 mm for each 10 cm section).

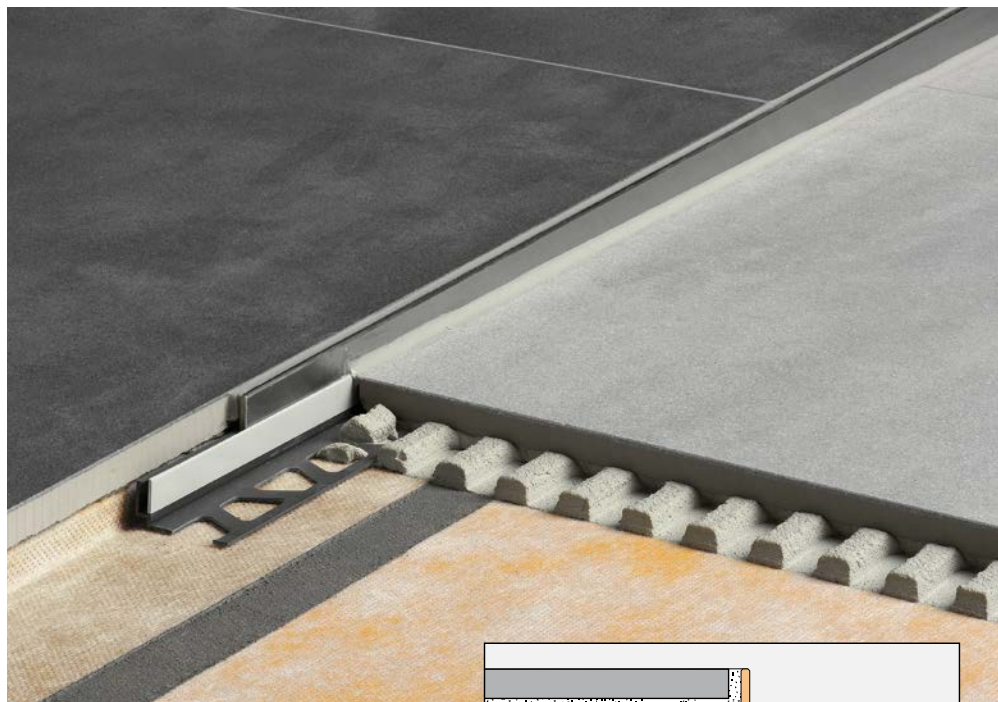

Schlüter-SHOWERPROFILE-R is a two-piece wall transition profile made of stainless steel V4A, available either with a brushed finish or a high-quality powder coating, for covering the wall area exposed due to the use of a wedge with a linear drainage channel. The profile has a fleece fabric laminated on the reverse side for bonding with the tile adhesive. Due to its two-piece design, SHOWERPROFILE-R can be seamlessly adjusted to any height between 23 and 45 mm (available in two versions). The profile is supplied in lengths of 100 cm, 140 cm and 200 cm, and can be cut to the required size.

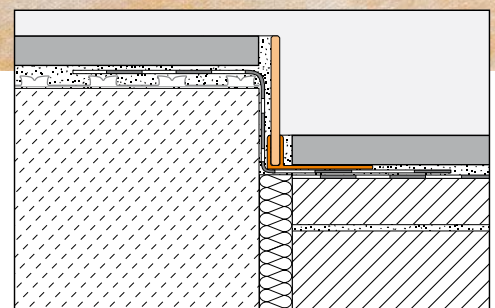

Schlüter®-SHOWERPROFILE-S

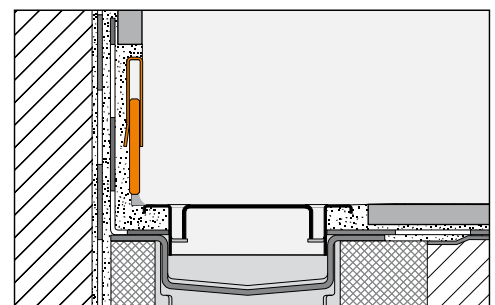

Schlüter®-SHOWERPROFILE-R



Material

stainless steel V4A

Material no. 1.4404 = AISI 316L

EB = brushed stainless steel V4A

TS = textured coated stainless steel V4A

The stainless steel profiles have a fleece fabric laminated on the underside for bonding with the tile adhesive. The SHOWERPROFILE-S support profile is made of plastic.

Materialeigenschaften und Einsatzgebiete:

SHOWERPROFILE-S and -R are available in a wide variety of finishes. Their suitability must be verified in applications exposed to chemical or mechanical stresses. The information provided below is intended as a general guideline. SHOWERPROFILE-S and -R of stainless steel V4A (material no. 1.4404 = AISI 316L), are especially suitable for applications requiring resistance against chemical exposure and high mechanical stresses. Even stainless steel of quality 1.4404 is not resistant to all chemical stresses, and may be affected by hydrochloric and hydrofluoric acid or certain chloride and brine concentrations, which may occur in cleaning agents or in swimming pools. Special anticipated stresses should therefore be verified in advance.

The TS finish (textured coated stainless steel V4A) features surfaces with a natural appearance. The stainless steel is suitably pre-treated and then powder coated with a polyurethane covering. The colour-stable coating is UV and weather-resistant. Visible edges should be protected against abrasion.

Installation

Schlüter®-SHOWERPROFILE-S

1. Cut the support profile to the required length and press its trapezoid-perforated anchoring leg firmly into the previously applied adhesive and align it.
2. Measure the required length and height of the triangular profile (front: low side; back: high side). Keep the insertion depth into the support profile in mind.
3. Cut the triangular profile to the required length to fit the proper height.

Note: Shorten the narrow and/or wide profile side to produce the proper height from the extra long profile. When working with profiles with an EB finish, remove the protective foil prior to installation. Apply tile adhesive to the fleece-laminated reverse side of the profile. Then insert it firmly into the U-shaped support profile and align it flush with the floor or wall.

Schlüter®-SHOWERPROFILE-R

1. Determine the length and height of the exposed wall area to be covered and cut the profile to the required length. When working with profiles with an EB finish, remove the protective foil prior to installation.
2. Connect SHOWERPROFILE-R to achieve the desired height.
3. Apply tile adhesive to the fleece-laminated reverse side of the profile. Then position the profile flush with the tile covering.

Notes

SHOWERPROFILE-S / -R requires no special maintenance or care. The profile can be cleaned along with the covering, using suitable detergents. The visible surfaces of the profiles can be polished with commercial chrome-polishing products. Stainless steel surfaces exposed to the environment or aggressive substances should be cleaned periodically using a mild household cleaner. Regular cleaning not only maintains the neat appearance of stainless steel, but also reduces the risk of corrosion.

All cleaning agents must be free of hydrochloric and hydrofluoric acid. Avoid the contact with other metals to prevent corrosion. This also includes installation tools such as trowels or steel wool, e.g. for the removal of mortar residue. Do not use abrasive cleaning agents on the sensitive surfaces. We recommend the use of the stainless steel cleaning polish Schlüter-CLEAN-CP.



Schlüter-SHOWERPROFILE-S

Installation in level-access shower floors



Schlüter-SHOWERPROFILE-S

Installation on walls



Schlüter-SHOWERPROFILE-R

Installation on walls



Product overview:

Schlüter®-SHOWERPROFILE-SA / -SB

EB = brushed stainless steel V4A

TS = textured coated stainless steel V4A

Length supplied: 1.2 m, 1.6 m and 2.0 m

Triangular profile H1= mm	SA	SB
	6	10
EB	•	•
TSI	•	•
TSG	•	•
TSSG	•	•
TSDA	•	•
MGS	•	•
MBW	•	•
TSBG	•	•
TSC	•	•
TSOB	•	•

Support profile H = mm	SA	SB
5	•	
10		•
12,5		•

Note:

Triangular profile: L = 120 cm, H2 = SA: 30 mm / SB = 34 mm

Triangular profile: L = 160 cm: H2 = SA: 38 mm / SB = 42 mm

Triangular profile: L = 200 cm: H2 = SA: 46 mm / SB = 50 mm

Support profiles from the Schlüter-DILEX-RF product range in heights of 15, 18 and 22 mm are available on request.

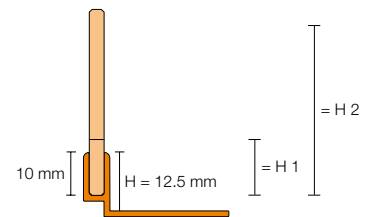
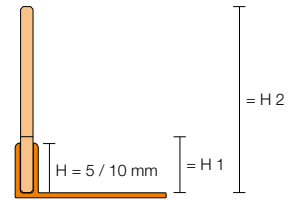

Schlüter®-SHOWERPROFILE-SA

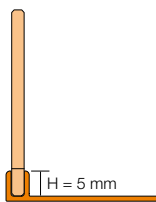

SPS 50

H = Height of support profile

SPS 50 is suitable for tile thicknesses of 6–9 mm

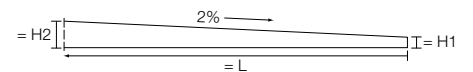

Triangular profile: L = 120 cm, H2 = 30 mm, H1 = 6 mm

Triangular profile: L = 160 cm, H2 = 38 mm, H1 = 6 mm

Triangular profile: L = 200 cm, H2 = 46 mm, H1 = 6 mm

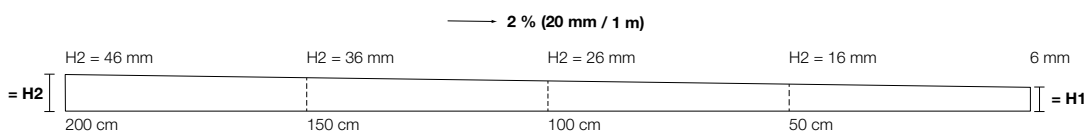

Schlüter®-SHOWERPROFILE-SB

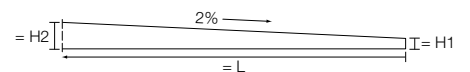
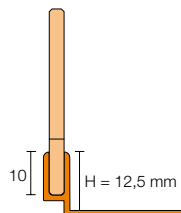
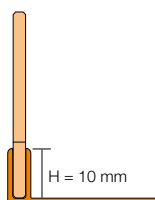

Triangular profile: L = 120 cm, H2 = 34 mm, H1 = 10 mm

Triangular profile: L = 160 cm, H2 = 42 mm, H1 = 10 mm

Triangular profile: L = 200 cm, H2 = 50 mm, H1 = 10 mm

SPS 100

H = Height of support profile

SPS 100 is suitable for tile thicknesses of 10–18 mm

SPS 125

H = Height of support profile

SPS 125 is suitable for tile thicknesses of 12.5–20 mm

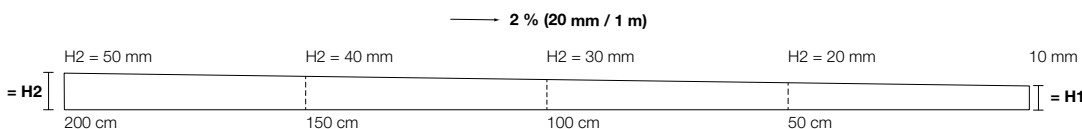



Schlüter®-SHOWERPROFILE-R

EB = brushed stainless steel V4A

TS = textured coated stainless steel V4A

Lengths supplied: 1 m und 1.4 m

H = mm	23-35	33-45
EB	•	•
TSI	•	•
TSG	•	•
TSSG	•	•
TSDA	•	•
MGS	•	•
MBW	•	•
TSBG	•	•
TSC	•	•
TSOB	•	•

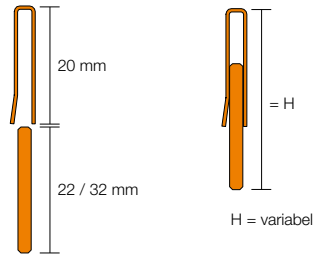

Colours:

- TSI = textured natural ivory
- TSG = textured natural grey
- TSSG = textured natural stone grey
- TSDA = textured, natural dark anthracite
- MGS = matte graphite black
- MBW = matte brilliant white
- TSBG = textured natural beige grey
- TSC = textured natural cream
- TSOB = textured natural bronze

Schlüter®-SHOWERPROFILE-R

EB = brushed stainless steel V4A

TS = textured coated stainless steel V4A

Lengths supplied: 2.0 m

H = mm	23-35	33-45
EB	•	•
TSI	•	•
TSDA	•	•
MGS	•	•
MBW	•	•
TSBG	•	•

Schlüter®-SHOWERPROFILE-SC

EB = brushed stainless steel V4A

Lengths supplied: 2.49 m

Triangular profile	SC
H1 = mm	6
EB	•

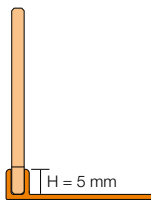

SC
Triangular profile:
SC is suitable for tile thicknesses of 6-15 mm

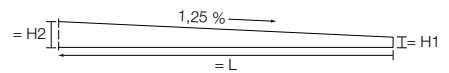

Triangular profile: L = 249 cm; H2 = 37,13 mm, H1 = 6 mm

Support profile

Lengths supplied: 2,00 m

Support profile	SC
H = mm	5
EB	•

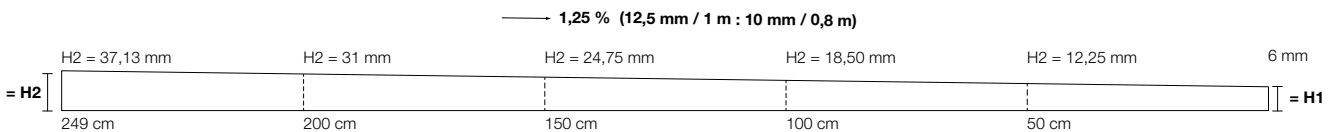

Schlüter-Systems KG | Schmölestraße 7 | D-58640 Iserlohn

+49 2371 971-0 | +49 2371 971-1111 | info@schluter.de | schluter-systems.com

Schlüter-Systems Ltd | Units 3-6 Bardon 22 Industrial Estate | Bardon Hill | Coalville | Leicestershire | LE67 1TE

+44 (0) 1530 813396 | sales@schluter.co.uk | schluter.co.uk