

Schluter®-KERDI-DRAIN & KERDI-DRAIN-H

POINT DRAIN WITH INTEGRATED BONDING FLANGE

Schluter®-KERDI-DRAIN

KERDI-DRAIN is a shower drain with an integrated bonding flange that provides a large contact area for a secure connection to the KERDI waterproofing membrane at the top of the assembly. KERDI-DRAIN consists of a drain body and fully adjustable grate assembly or covering support to which tile is applied. The standard KERDI-DRAIN is attached directly to the waste line. KERDI-DRAIN is used when topical waterproofing such as KERDI will be the primary waterproofing for a drainage system including mortar beds, and with KERDI-SHOWER SHOWER-T/-TS/-TT trays.

Schluter®-KERDI-DRAIN-H

KERDI-DRAIN-H is a shower drain with an integrated bonding flange that provides a large contact area for a secure connection to the KERDI waterproofing membrane at the top of the assembly. KERDI-DRAIN-H provides a horizontal connection to the waste line, and is appropriate for both mortar bed and KERDI-SHOWER-T/-TS/-TT shower tray applications. It is ideal for applications where the use of a vertical connection to the waste line is not possible or practical (e.g., suspended or post-tension concrete floors, basement slabs, or wood floor installations where relocating the hole in the floor is not practical).

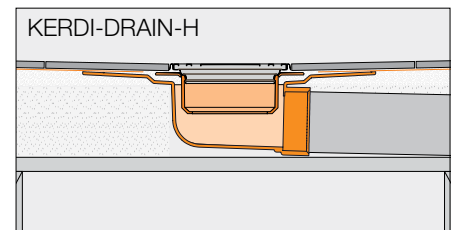
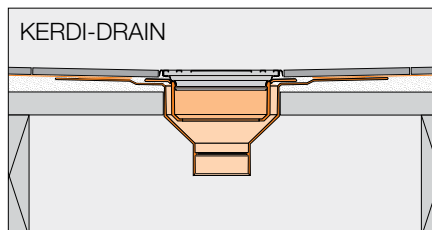
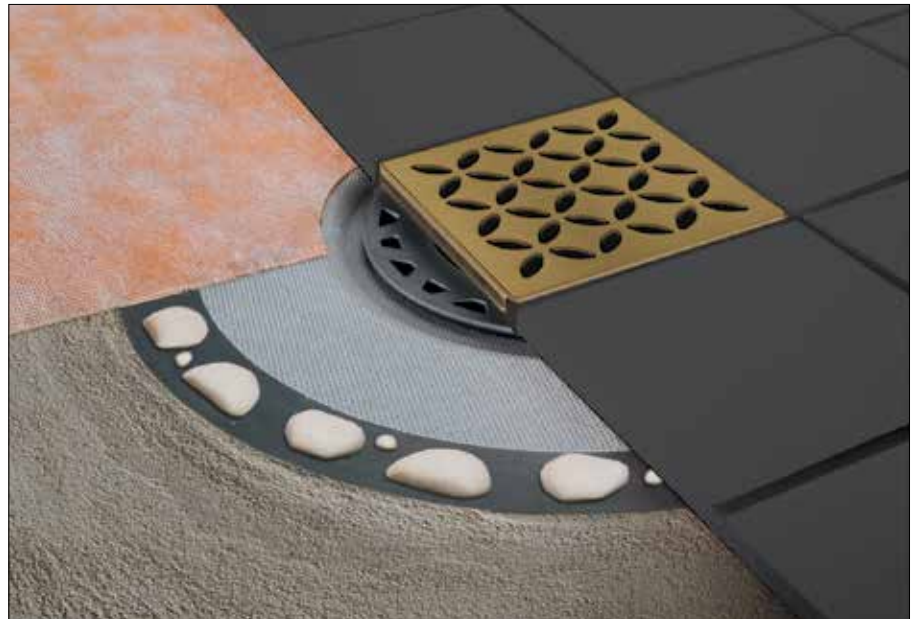

Features and Benefits

KERDI-DRAIN

- Available as ABS or PVC flange with a 2" (50 mm) or 3" (75 mm) outlet
- Also available as stainless steel flange with a 2" (50 mm) or 3" (75 mm) no-hub outlet or a 2" (50 mm) threaded outlet
- The grate assembly accommodates a wide range of tile thicknesses and allows lateral and tilt adjustment as well
- Grate available in a wide range of finishes and colors in stainless steel or anodized aluminum, as well as a tileable option
- The TILE grate/covering support is placed flush with the top of the bonding flange and can therefore accommodate any thickness tile covering

KERDI-DRAIN-H

- The height compensation board, KERDI-SHOWER-CB can be used to accommodate the drain body and waste pipe height when installing KERDI-DRAIN-H in conjunction with the KERDI-SHOWER-T/-TS/-TT shower trays.
 - Integrated sloped bonding flange with horizontal connection
 - Available in ABS or PVC with a 2" (50 mm) outlet
 - Ideal for applications where the use of a vertical connection to the drain pipe is not possible

- KERDI-SHOWER-CB height compensation board meets the height of KERDI-SHOWER-T/-TS/-TT shower trays and is available separately
- Choice of compatible KERDI-DRAIN grates are available

Material

- The KERDI-DRAIN flange is available in:
 - ABS
 - PVC
 - Stainless steel 304
- The KERDI-DRAIN-H flange is available in:
 - ABS
 - PVC
- The plastic drain bodies feature a polypropylene fleece-covered bonding flange.
- Drain grates are available in plain and coated stainless steel 304 (1.4301 = V2A) and anodized aluminum. The TILE grate/covering support is stainless steel 304 (1.4301 = V2A) with KERDI laminated on the surface.



Where to Use

- Use in showers, steam showers, wet area drainage, and other applications where the primary waterproofing for the system is on the same level as the top of the drain flange
- Interior, in conjunction with KERDI-SHOWER-T/-TS/-TT prefabricated shower trays and mortar beds
- Suitable for use in residential and commercial applications, including areas subject to foot and wheelchair traffic, such as showers and wet rooms in homes, hotels, schools, healthcare facilities, etc
- The simple connection to standard drain outlets makes KERDI-DRAIN suitable for new construction and renovation

Limitations

- Limit the diameter of the hole to 5" (125 mm) maximum to ensure proper support of the tile assembly. For holes larger than 5" please contact Schluter-Systems Technical Services Representatives at 800-472-4588 (USA) or 800-667-8746 (Canada) for more information.
- Not for use in showers with a primary waterproofing under the mortar bed (traditional 'clamping ring') showers.
- When using a flange with a 3" (75 mm) outlet, a 6" (150 mm) grate is recommended.

Allowable Substrates

- Schluter prefabricated shower trays: KERDI-SHOWER-T/-TS/-TT
- Portland cement mortar bed with KERDI waterproofing on top
- KERDI-SHOWER-CB height compensation board for installation in conjunction with Schluter prefabricated KERDI-SHOWER-T/-TS/-TT shower trays, when installing KERDI-DRAIN-H flanges with horizontal outlet.

Preparation

- After locating the correct position, cut a hole in the substrate for the drain outlet and coupling to the waste line using the template provided.

Note: Fill in box-outs in concrete floors with dry-pack mortar. A pipe coupling or similar can be used as a form around the waste line. Select form to accommodate the drain outlet and mechanical no-hub coupling (when applicable).

Installation

- The no-hub outlets are attached to the pipe using an appropriate mechanical (e.g., flexible or no-hub) coupling.
- For ABS and PVC materials, attach to the pipe use an appropriate solvent cement.
- The threaded outlets are attached to the pipe using thread sealing compound or tape.
- A water test is strongly recommended before setting tile to verify a successful installation. Wait 24 hours minimum after the membrane installation to allow for final set of the mortar before flood testing to ensure waterproof performance of the assembly at seams and connections. Refer to local plumbing codes for any specific requirements in your area.
- KERDI-DRAIN and KERDI-DRAIN-H have adjustable height grate assemblies, and must be installed at or below the level of the surrounding tiles to ensure proper drainage.

Note: Installation instructions for the use of KERDI-DRAIN in shower applications can be found in the Schluter-Shower System Installation Handbook.

Maintenance and Cleaning

Clean the grates using a neutral cleaner. Avoid the use of strong acids (e.g., hydrochloric, hydrofluoric) and bases/alkaline cleaners (e.g., bleach, ammonia, chlorides). Do not use abrasive cleaning agents and tools. Even stainless steel requires periodic cleaning, which will maintain a neat appearance and reduce the risk of corrosion. Stainless steel surfaces develop a sheen when treated with a chrome-polishing agent. The KERDI-DRAIN strainer requires regular cleaning to prevent hair buildup.

Protection

- Cover the opening of the KERDI-DRAIN while installing and grouting tile, painting, and other finishing steps.
- Do not wash buckets containing mortar and grout residue into KERDI-DRAIN.
- Do not place ladder legs or other point loads on KERDI-DRAIN base or grates.
- KERDI-DRAIN and KERDI-DRAIN-H require no special maintenance and are resistant to mold and fungi. The drain grate may be removed to clean the drain housing and the drain pipes.

Note: Schluter-Systems drain grates are resistant to most chemicals encountered in tiled environments. In special cases, the suitability of a proposed type of material must be verified based on the anticipated chemical, mechanical, and/or other stresses. In general, grates should be protected against abrasion or scratching.

Schluter®-KERDI-DRAIN and KERDI-DRAIN-H

| Industry Standards | |
|---|---|
| ICC-ES Report No. ESR-2467 and PMG-1204 | Pass |
| Various configurations of KERDI-DRAIN and KERDI-DRAIN-H, are listed by UPC®, CSA, and ICC-ES PMG. | |
| Product Characteristics | |
| Composition | ABS, PVC, Stainless Steel 304 |
| Color | Black (ABS), Gray (PVC), Silver (stainless steel) |
| Sustainability Information | |
| VOC tested | LEED Compliant |
| SDS | Available |



Product Table

8.2 Schluter®-KERDI-DRAIN



4" Grate Options

Tileable Covering Support

Anodized Aluminum

Stainless Steel



TILE (ECS)

Available in the following colors and finishes.



CONTOUR

- Brushed Nickel (ATGB)
- Brushed Brass (AMGB)
- Brushed Copper (AKGB)

Available in the following colors and finishes.



CLASSIC

- | | |
|-------------------------|--------------------|
| Stainless Steel (E) | Nickel (ET) |
| Chrome (EP) | Vintage Gold (EVG) |
| Oil-rubbed Bronze (EOB) | Classic Gold (ECG) |

Stainless Steel



PURE



CURVE



FLORAL

Available in the following colors and finishes.

- | | | | |
|------------------------------|------------------------|-----------------------------|-----------------------------|
| Brushed Stainless Steel (EB) | Brushed Nickel (EBT) | Brushed Vintage Gold (EBVG) | Brushed Classic Gold (EBCG) |
| Ivory (TSI) | Greige (TSBG) | Cream (TSC) | Bronze (TSOB) |
| Pewter (TSG) | Dark Anthracite (TSDA) | Matte Black (MGS) | Matte White (MBW) |
| Stone Grey (TSSG) | | | |

Note: The EBT, EBVG, and EBCG finishes are not available for the SQUARE, QUAD, PARALLEL, and DIAGONAL grates.



SQUARE



QUAD



PARALLEL



DIAGONAL

6" Grate Options

Stainless Steel

Stainless Steel Cover for Cleanout Applicatoinis



CLASSIC (6E)



CLASSIC ROUND (6E)



(6CE)



Schluter®-KERDI-DRAIN

Flange Options

| | | | |
|-----------------------|-----------------------|--|--------------------------------------|
| ABS - 2" or 3" Outlet | PVC - 2" or 3" Outlet | Stainless Steel - 2" or 3" No hub Outlet | Stainless Steel - 2" Threaded Outlet |
|-----------------------|-----------------------|--|--------------------------------------|



ABS or PVC Flange - 2" or 3" Outlet

| 2" (50 mm) drain outlet | | 3" (75 mm) drain outlet | |
|---|-------------|---|-------------|
| Material | Item No. | Material | Item No. |
|  ABS | KD2 FLK ABS |  ABS | KD3 FLK ABS |
|  PVC | KD2 FLK PVC |  PVC | KD3 FLK PVC |

Additional components included



Flange measurements

ABS or PVC

|  | 50 mm - 2" drain outlet | 75 mm - 3" drain outlet |
|---|-------------------------|-------------------------|
| | A | 300 mm - 11-13/16" |
| B | 115.2 mm - 4-17/32" | 115.2 mm - 4-17/32" |
| C | 68.6 mm - 2-45/64" | 100 mm - 3-15/16" |
| D | 60.5 mm - 2-3/8" | 88.8 mm - 3-1/2" |
| E | 100 mm - 3-15/16" | 100 mm - 3-15/16" |
| F | 40.6 mm - 1-39/64" | 50.8 mm - 2" |
| G | 22.5 mm - 7/8" | 38.1 mm - 1-1/2" |

When using a flange with 3" outlet, 6" grate is recommended.



Schluter®-KERDI-DRAIN

Stainless Steel Flange - 2" or 3" Outlet

2" (50 mm) drain outlet

3" (75 mm) drain outlet



No-hub
Item No. - KD2 FLK E

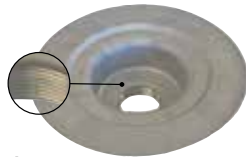

Threaded
Item No. - KD2 FLK ETH



No-hub
Item No. - KD3 FLK E

Additional components included



4x
Inside corners



2x
Outside corners



1x
Pipe seal
(20 mm - 3/4")



1x
Mixing valve seal
(114 mm - 4-1/2")



1x
KERDI-FIX
sealing and bonding
compound
(100 ml - 3.38 fl oz)

Flange measurements

Stainless steel

| | 50 mm - 2" no-hub outlet | 75 mm - 3" no-hub outlet |
|---|--------------------------|--------------------------|
| A | 250 mm - 9-27/32" | 250 mm - 9-27/32" |
| B | 115.4 mm - 4-1/2" | 114 mm - 4-1/2" |
| C | 61.3 mm - 2-13/32" | 87.4 mm - 3-7/16" |
| D | 60.6 mm - 2-13/32" | 84.2 mm - 3-5/16" |
| E | 85 mm - 3-11/32" | 87.4 mm - 3-7/16" |
| F | 21 mm - 53/64" | 29.4 mm - 1-5/32" |

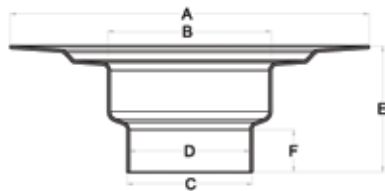

When using a flange with 3" outlet, 6" grate is recommended.

Schluter®-KERDI-DRAIN-H

ABS or PVC Flange - 2" Outlet Horizontal

2" (50 mm) drain outlet

Additional components included



ABS
Item No. - KDH2 FLK ABS



PVC
Item No. - KDH2 FLK PVC



4x
Inside corners



2x
Outside corners



1x
Pipe seal
(20 mm - 3/4")



1x
Mixing valve seal
(114 mm - 4-1/2")

Flange measurements

ABS or PVC

| | 50 mm - 2" horizontal drain outlet |
|---|------------------------------------|
| A | 300 mm - 11-13/16" |
| B | 118.3 mm - 4-21/32" |
| C | 69.5 mm - 2-47/64" |
| D | 60.5 mm - 2-3/8" |
| E | 85.7 mm - 3-3/8" |
| F | 27 mm - 1-1/16" |

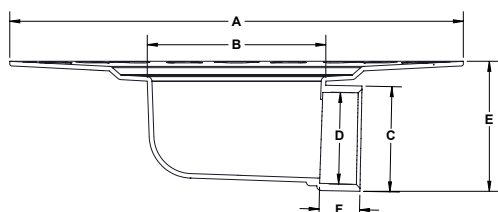



Additional Resources Available Online:

- Shower System Installation Handbook
- Safety Data Sheets
- Installation and Instruction Videos

For KERDI-DRAIN: www.schluter.com/schluter-us/en_US/Shower-System/Drains/Shower-Drains/p/KERDI_DRAIN

Or scan here:



For KERDI-DRAIN-H: www.schluter.com/schluter-us/en_US/Shower-System/Drains/Shower-Drains/p/KERDI_DRAIN-H

Or scan here:



Warranties:

Schluter-Systems products and systems are covered under our warranty program, as applicable. For details and to access Schluter-Systems' warranty documents:

Visit www.schluter.com/warranties

Or scan here:



To obtain hard copies, please contact Customer Service at: 800-472-4588 (USA) or 800-667-8746 (Canada).

